

GREER, S.C.

3-17-72 Scale 1/8"=1'

KEY

- Commode
- Lavatory
- ⊗ Telephone

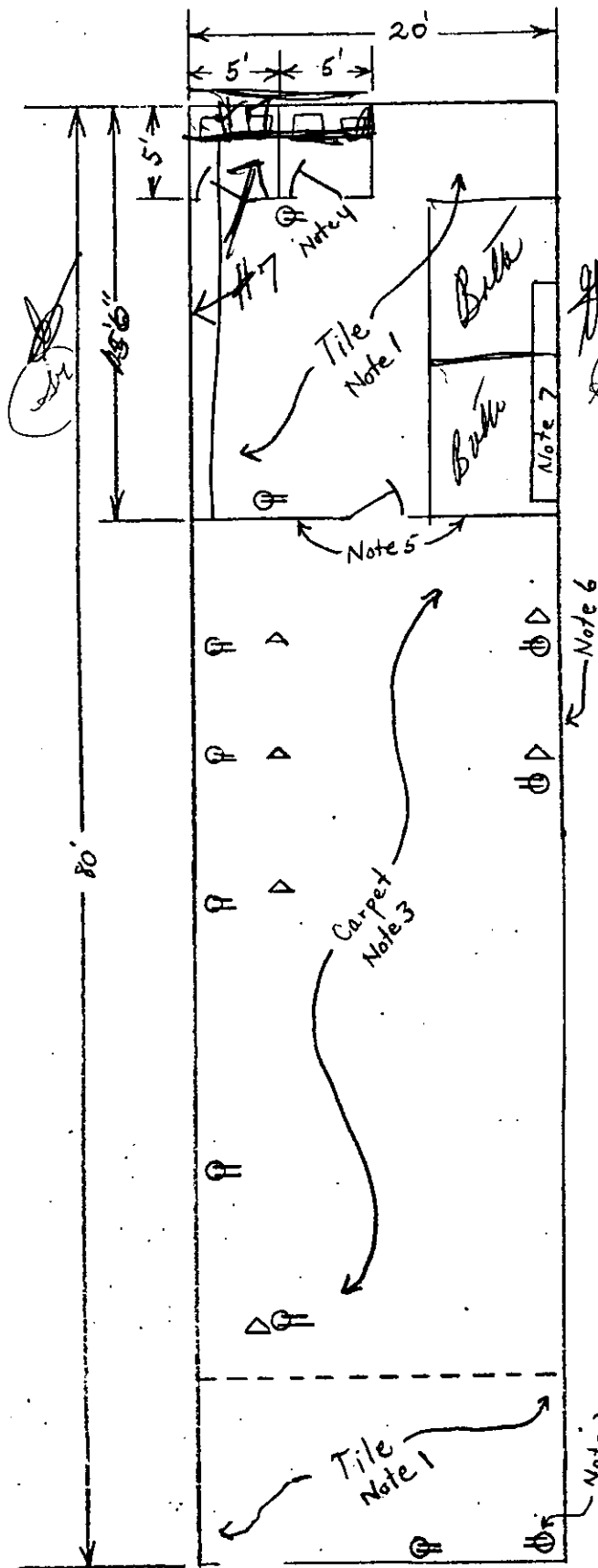

Note 1 - Lobby - Rest Room - Storage Area in Armstrong Imperial Texture # 51839 Fortress White by Lessor

Note 2 - Electrical Supply for Outside Sign

Note 3 - Carpet by CCC with Mohawk ST9000 M/Kenzie Scotch Plaid over 4oz Rubberized Hair & Jute Pad with #270 per sq yard allowance in lieu of Tile by Lessor

Note 4 - Electrical - Cold water and Drain Supply for Water cooler, Lessor To Supply Westinghouse Model WFC04GT fountain.

Note 5 - Rear Wall ~~and Trim painted~~ O'Brien "King Fishery Blue" ~~by Lessor~~ ~~Decor~~ ~~formery~~

Note 6 - Side walls and Trim painted O'Brien "Lowell Grey" by ~~Lessor~~ ~~Decor~~ ~~formery~~

Note 7 - Storage Shelves supplied by Lessor ~~being~~ 6' High 15 1/2" Deep with shelves 12" on center left side Wall & Rear Wall

(CONTINUED ON NEXT PAGE)

*[Handwritten signature]*